

SL55 - Softline Cutter Part No - 980504

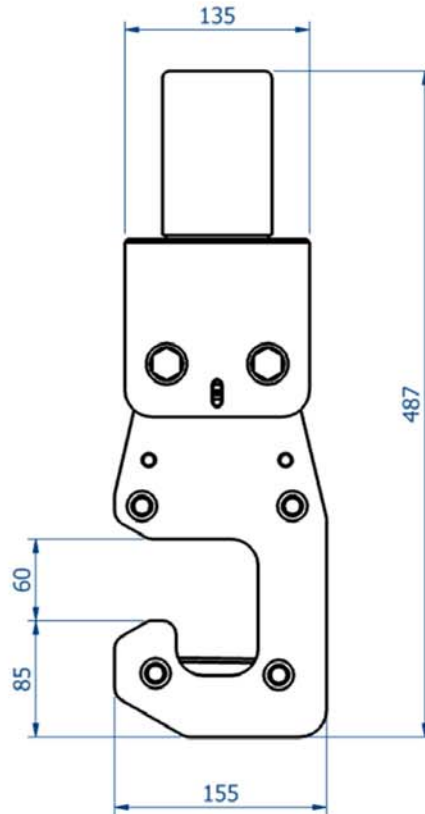
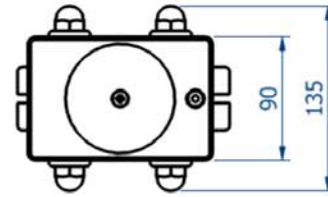

- Heavy duty hydraulically operated soft and fibre line cutting tool
- Lightweight aluminium and stainless steel construction
- Diver or ROV operable design
- Quick and efficient operation
- Long blade life ensures that tool maintenance is kept to a minimum
- Can be used at any water depth
- Cutting capacity – Maximum \varnothing 55mm fibre rope
- Maximum operating pressure 210 bar
- Approx weight in air – 10kg
- Approx weight in water – 7kg
- Swept volume cut stroke – 0.25 litres
- Swept volume return stroke – 0.2 litres
- Standard tool is shown above. Bespoke and custom designs to suit special applications are available on request

Sydney (Head Office)
131 WOIDS AVENUE
CARLTON NSW 2218
TEL: (02) 9547 1844
FAX: (02) 9547 2236
sales@specialisedforce.com.au

Brisbane
2/68 NORTHLINK PLACE
NORTHGATE QLD 4013
TEL: (07) 3256 6011
FAX: (07) 3256 6055
qldsales@specialisedforce.com.au

Townsville
2/1 CIVIL ROAD
GARbutt QLD 4814
TEL: (07) 4728 8756
FAX: (07) 4725 4380
nqklsales@specialisedforce.com.au

Adelaide
316 SOUTH ROAD
RICHMOND SA 5033
TEL: (08) 8352 8866
FAX: (08) 8352 7257
sasales@specialisedforce.com.au

Darwin
PO BOX 467 (4/17 WILLES RD)
BERRIMAH NT 0828
TEL: (08) 8984 4453
FAX: (08) 8984 4390
ntsales@specialisedforce.com.au

Melbourne
2/18 SOUTHFORK DRIVE
KILSYTH VIC 3137
TEL: (03) 9761 4199
FAX: (03) 9761 4966
vic-sales@specialisedforce.com.au

Perth
17 & 19 AUGUSTA STREET
WILLETTON WA 6155
TEL: (08) 9354 8544
FAX: (08) 9354 8360
wasales@specialisedforce.com.au

Port Hedland
4/13 CAJARINA RD
WEDGEFIELD WA 6721
TEL: (0417) 544 475
FAX: (08) 9354 8360
phtsales@specialisedforce.com.au