



THE **SDN** SERIES JACK IS AN ERGONOMICALLY DESIGNED PORTABLE JACKING SYSTEM THAT IS EASILY WHEELED AROUND A JOB SITE.

This unit is designed for lifting of heavy mining vehicles. It can be used on any hard surface (maintenance bays & workshops) and is easily transported by ute to site in an emergency. The wheeled chassis has an ergonomically designed handle system which is adjustable, making it easy to move around with a single person. The chassis frame is steel and not cast for maximum durability and longevity. For safety a 5.0 m remote control pendant is supplied to keep the operator out of the way of any possible hazards. U-rings and extensions are available.



+ **POWERDRIVE**



Model No.	Jack Capacity			Cylinder Effective Area (cm ²)	Collapsed Height (mm)**	Stroke (mm)	Powerdrive Option (Y/N)	Oil Tank Capacity (L)	Weight (kg)
	Metric (tonne)	US (ton)*	(kN)						
SDN-10068	100	110	980	143	680	400	N	24	346
SDN-10068-PD	100	110	980	143	680	400	Y	24	346
SDN-10086	100	110	980	143	860	571	N	24	381
SDN-10086-PD	100	110	980	143	860	571	Y	24	381

OIL RETURN LINE FILTER

included as standard

HYDRAULIC SYSTEM

is powered by a Gast 3.9kW air motor

LOAD LOWERING

counter balance valve for smooth controlled lowering of load

PNEUMATIC CONTROL VALVES

for precise lifting and lowering

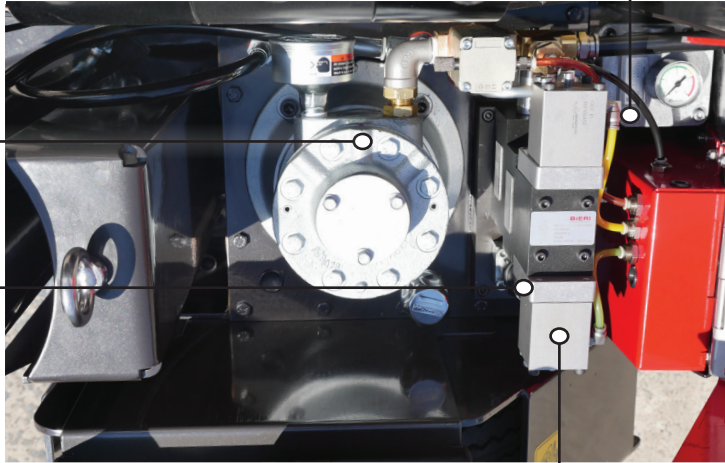

CAPACITY

100 tonne
(110 US ton)

STROKE RANGE

400 - 571mm

TILT ADJUSTABLE HANDLE

for ease of manoeuvring and compact storage

SERRATED LOAD CAP

included as standard

U-RINGS

for mechanical load support

LIFTING POINT

for central lifting

5 METRE PENDANT

steel cored, flexible conduit

U-RING HOLDER

LIFTING POINT

allows easy forklift access with a 160mm max. tine width

ON BOARD

pneumatic filter/regulator and lubricator

LOCKABLE ISOLATION VALVE

relieves downstream air for extra safety and security

RESERVOIR SIGHT GAUGE

to monitor oil level

TYRES WITH ALLOY RIMS

heavy duty, polyurethane filled, puncture-proof, large rolling diameter (450mm)

HIGH STRENGTH STEEL BASE PLATE

resists deformation

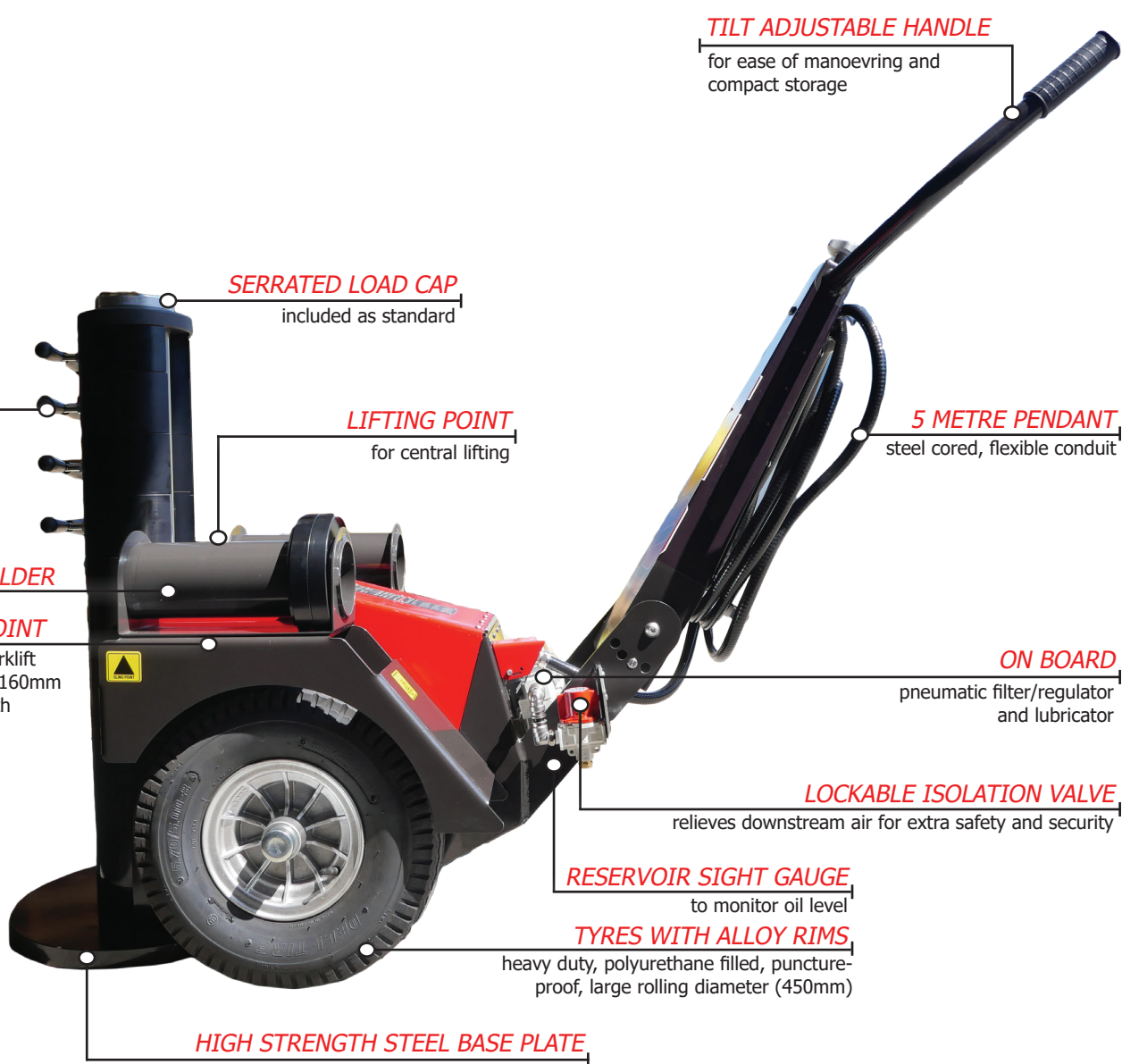

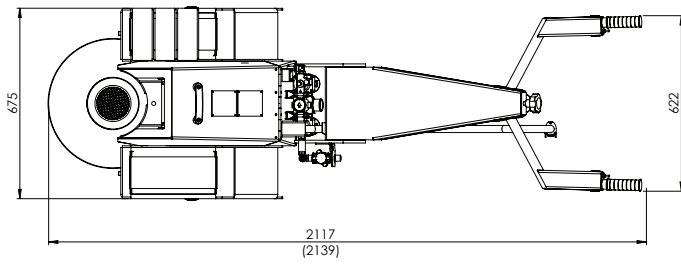

WARNING

No more than one extension to be used

Model No.	A Collapsed Height (mm)	B Base Plate Diameter (mm)
SDN-10068	689	460
SDN-10068-PD	689	460
SDN-10086	860	505
SDN-10086-PD	860	505

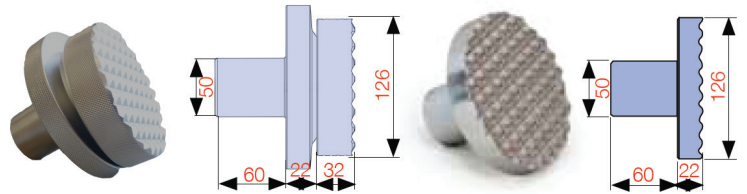
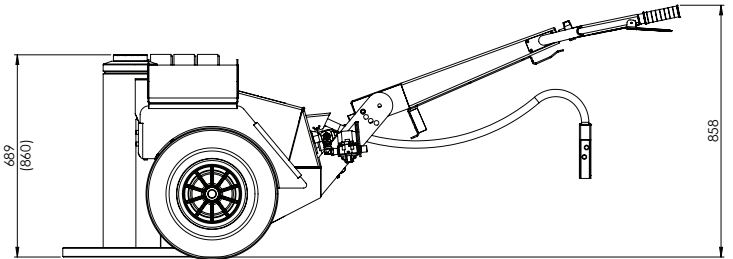

SDS-150/200N

SDLC-150

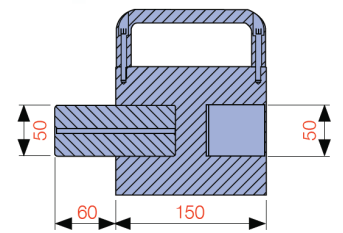
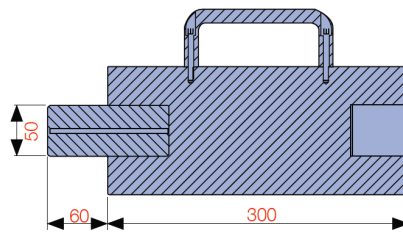

SDE150-300

SDE150-150

Model No.	Capacity (tons)	Description	Height (mm)	Diameter (mm) 'A'	Total Length (mm)	Spigot Depth (mm)	Spigot Diameter (mm)	Weight (kg)
SDE100-150	70/100	150 mm Extension**	150	112	210	60	50	7.0
SDE100-300	70/100	300 mm Extension**	300	112	360	60	50	13.0
SDLC-100	70/100	Serrated Steel Load Cap*	22	112	82	60	50	3.0
SDS-100	70/100	Serrated Tilt Saddle**	50	112	110	60	50	5.0
SDE150-150	150	150 mm Extension**	150	126	210	60	50	7.0
SDE150-300	150	300 mm Extension**	300	126	360	60	50	13.0
SDLC-150	150	Serrated Steel Load Cap*	22	126	82	60	50	3.0
SDS-150	150	Serrated Tilt Saddle**	50	126	110	60	50	5.0
SDE200-150	200	150 mm Extension**	150	140	210	60	50	8.0
SDE200-300	200	300 mm Extension**	300	140	360	60	50	15.0
SDLC-200	200	Serrated Steel Load Cap*	22	126	82	60	50	4.0
SDS-200	200	Serrated Tilt Saddle**	50	126	110	60	50	6.0
SDNU-15	15	15T U Ring Saddle						
SDNU-25	25	25T U Ring Saddle						
SDNU-75	75	75T U Ring Saddle						
SDNU-100	100	100T U Ring Saddle						
SDNU-250	250	250T U Ring Saddle						