



SWAGER, BATTERY HYDRAULIC & SLEEVES (MADE IN JAPAN)

For swaging 6-12mm (1/4-1/2") wire rope together. Arm swaging tools and Arm oval sleeves must be used in conjunction (do not use other brands of crimpers with sleeves and vice versa).



Model No.	HS12-LI230
Battery Voltage (VDC)	25.2V
Battery Type	LI-Ion 4.0 AH
Output Force (ton)	10
Size (mm) L x W x H	355 x 90 x 350
Swaging Speed (sec)	7
Charging Time (min)	120
Accessories (Included in kit)	Tool, 1 x Batteries, 230VAC Charger, Check Gauge, RC-450 Cutter, Die Removing Tool, Operating Instruction Scan Code in the Case & Carry Case



BC 0075G (230V) Charger

BPL-2540 Battery



MODEL NO. HS12-230V ELECTRIC HYDRAULIC SWAGER (MADE IN JAPAN)

Model No.	HS12-230V
Swaging Capacity (mm)	6 – 12mm Wire Rope
Voltage (VAC)	230
Output Force (ton)	11
Tool Weight (kg)	7.5
Gross Weight (kg)	18
Dimensions (mm)	433 x 104 x 243
Swaging Speed (sec)	18
Accessories	4 set dies, RC450 Wire Rope Cutter, Screw Driver (For Replacing Dies), Shoulder Strap, Carry Case & Check Gauge

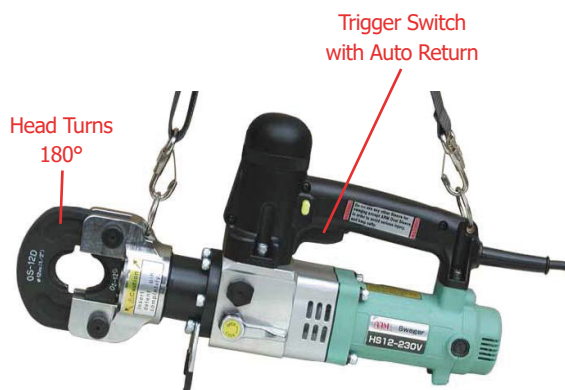

SUITABLE SLEEVES FOR HS12-LI230 & HS12-230V

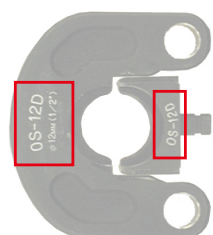

Dies	Oval Sleeve	Wire Rope Dia. (mm)
OS-6D	OS-6A	6
OS-8D	OS-8A	8
OS-9D&10D	OS-9A	9
OS-9D&10D	OS-10A	10
OS-12D	OS-12A	12

**REFER PAGE 39 FOR
ARM SWAGING SLEEVE
AND TOOL TECHNICAL
INFORMATION**

4 set dies included with HS12-LI230 and HS12-230V tool.