

SF *Capability Statement*

**QUALITY
SALES
SERVICE
SOLUTIONS**

**Offering Quality Tools/Equipment, Services and Solutions across Australia through our
National Branch and Workshops Network**

Why Choose Specialised Force

- More than 35 years of experience in supplying high quality tools/equipment, from around the world.
- A proven competent, widespread service network which is supported by a national infrastructure to deliver service, parts and components.
- A reliable partner who can not only supply the equipment you need, but also has in-depth application knowledge of your working environment

Key Values



Excellence

We apply advanced technology, and continually innovate and improve.



Safety

Zero accidents is our unwavering goal



Fair Return

We earn a return that fairly rewards the value we deliver



Sustainability

We plan and act for the future - considering our company, our customers, and our world.



Ethics:

Uncompromising integrity, honest and fairness are at the heart of our company.

Company Overview

Specialised Force Pty Ltd has been operating and expanding throughout Australia since 1982. With the Head office in Sydney, the company now operates in Brisbane, Townsville, Darwin, Adelaide, Melbourne, Perth, Port Hedland and Hobart.

We pursue a "complete system" approach and carefully match components to ensure efficient and safe operation of equipment. We have got what you need from small pumps and ram sets, through to the design and supply of large computer-controlled jacking systems for specific applications. Our in-house and mobile Workshop facilities enable our service, repair and testing of equipment to standards that ensure compliance and fit for purpose outcomes.

specialisedforce.com.au

Follow us



Electrical - Rail - Mining - Oil & Gas - Civil Infrastructure - Industrial - Communications - Transport



Sydney - Brisbane - Townsville - Adelaide - Darwin - Melbourne - Hobart - Perth - Port Hedland



Specialised tools, equipment, service and solutions for civil infrastructure projects, maintenance or new construction

Key Tools / Equipment

- Rebar Cutter / Bender
- Metal Punch Set
- Transport Trolleys
- Load Skates
- Hydraulic Post Drivers
- Flush Cut Saws
- Hydraulic Breakers
- Screw Jacks
- Post-Tensioning and Pre-Stressing Jacks
- Tube and Pipe Benders
- Hydraulic Power Units
- Hydraulic Cylinders
- and Much More...

Major Clients

Balfour Beatty

LEIGHTON

UGL

JOHN HOLLAND

LAING O'ROURKE

NSW Transport RailCorp

Downer
Relationships creating success

KENNARDS HIRE

Australian Government
Department of Defence

lendlease

Key Partners

Tractel

DURAPAC

MARUZEN



alkitronic
HOME OF TORQUE POWER



HILMAN ROLLERS
WWW.HILMANROLLERS.COM



IZUMI

JOYCE

TORO Fusion



ORIONE



DIAMOND

Significant Projects

SYDNEY METRO
2017- STAGE 1;
Client: CPB-JOHN HOLLAND-UGL; Supply of Hydraulic Tools to TBM Install Team and Mechanical Maintenance Crews.

2019- STAGE 2 (Ongoing); Client: JOHN HOLLAND - CPB - GHELLA; Supply of Hydraulic tools for TBM Maintenance and Tunneling Teams.

HORNIBROOK TULLAMARINE PORT MELBOURNE FREEWAY EXTENSION

2019- WESTCONNEX M5 (M8); Client: CPB - DRAGADOS - SAMSUNG; Supply of Hydraulic tools for Road Header Maintenance and Tunneling Teams.

2019- WESTCONNEX M4; Client: CPB; Supply of 700 BAR Hydraulic tools for Road Header Maintenance and Tunneling Teams.

TRANSFIELD NORTH-SIDE STORAGE TUNNEL



Specialised tools, equipment, service and solutions for new construction or maintenance of Communication projects

Key Tools / Equipment

- Rollers
- Swivels
- Wire Grips
- Dynamometers
- Cable Drum Jacks
- Conduit Rope Blowers
- Telecommunication Rope
- Tirfor Hoists
- Wire Tension Meter
- Bird Diverters
- Portable Winches
- Rope Blowers
- Swivels and Fuses
- Compression Dies
- Tool Aprons and Buckets
- and Much More...

Major Clients



Key Partners





Specialised tools, equipment, service and solutions for overhead and underground electrical installation

Key Tools/Equipment

- Overhead & Underground Power Installation Tools
- Cable Hauling & Terminating Equipment
- Cable Pulling & Stringing Machinery
- Substation Construction Tools
- Cable Cutters & Crimpers
- Hole Making and Bending
- Guards & Warning Markers
- Cable Preparation
- Insulated Gloves & Sleeves
- Line Swivels
- Pole Chainsaw
- Fibreglass Rodders
- and Much More...

Major Clients



Key Partners



Significant Projects

- SYDNEY METRO**
 2017- **STAGE 1**;
 Client: CPB-JOHN HOLLAND- UGL; 2019- **STAGE 2 (Ongoing)**;
 Supplied Cable Handling, Cable Winches and Cable Hauling Gear to Electrical Teams across the project
- ELECTRICITY COMMISSION OF VICTORIA**;
 Supply of 150 Fairmont H8508 Impact Wrenches
- BARROW ISLAND**;
 Supply of Electrical Equipment
- LNG**;
 Supply of Electrical Equipment
- MONADELPHOUS MINING**; Supply of Electrical Equipment
- NORTH CONNEX**;
 Supplied Cable Handling, cable winches and cable Hauling gear to Electrical Teams across the project
- 2019- WESTCONNEX M5 (M8)**;
 Client: CPB - DRAGADOS - SAMSUNG;
 Supplied Cable Handling, Cable Winches & Cable Hauling Gear to Electrical Teams across the project



- Torque Wrenches
- Flange Maintenance Tools
- Jacks
- Lifting Systems
- Tool for Heat Exchanger/Boilers
- 700 BAR Lifting and Maintenance Tools
- Underground Miner's Pumps
- Torque Wrench Pumps
- Hydraulic Cylinders
- Bolt Cutters
- Wire Rope Cutter
- Hydraulic Couplers & Fittings
- Hydraulic Spreaders
- Hydraulic Track Pin Press
- and Much More...

Key Partners



- | | | |
|---|--|---|
| <p>2018- PILBARA IRON (Ongoing);
Supply of Hydraulic tools to support operation improvement initiatives along with Asset Management Services</p> | <p>2018- BHP (Ongoing);
Supply of Hydraulic tools to support operation improvement initiatives along with Asset Management Services</p> | <p>BHP OF MOUNT NEWMAN; Supply of 2000 Tonne Jacking System for Stacker Reclaimers</p> |
| | | <p>MONADELPHOUS MINING; Supply of Electrical Equipment</p> |
| | | <p>RGC MINERAL SANDS; Supply of 3,000 Tonne Jacking System</p> |



Specialised tools, equipment, service and solutions for the industrial sector

Key Tools/Equipment

- Heavy Load Lifting/Shifting, Maintenance and Safety Equipment
- Torque Wrenches
- Hydraulic Jacks
- Hydraulic Cylinders
- Knockout Punch Driver
- Auger Bits
- Cutter/Benders
- Transport Trolley
- Hydraulic Breakers
- Hydraulic Concrete Crusher
- Hydraulic Swagers
- Hydraulic Pullers
- Hydraulic Pumps
- and Much More...

Major Clients

JOHN HOLLAND

UGL



Downer
Relationships creating success

Zinfra
Your trusted partner in energy



KENNARDS HIRE



LAING O'ROURKE



LEIGHTON

snowyhydro

Key Partners



Significant Projects

- ◆ **CHINA AIR PROJECT;** Supply of Clyde Carruthers of Special Worm Screw Lifting Jacks for Aircraft Maintenance
- ◆ **AIR INDIA PROJECT;** Supply of Clyde Carruthers of Special Worm Screw Lifting Jacks for Aircraft Maintenance
- ◆ **QANTAS 747 PLANES;** Supply of Special Worm screw Lifting Jacks for Fuselage Maintenance
- ◆ **QANTAS SYDNEY JETBASE;** Supply of Torque Multiplier for Engine Maintenance
- ◆ **KRUPP AT HAYPOINT, QUEENSLAND;** Supply of Special 1200 Tonne Jacking System. Our Melbourne Office People also Commissioned Equipment and were on Site for a Week During Lifting Operation
- ◆ **NEW ZEALAND ALUMINIUM SMELTERS;** Supply of Anode Jacks



Specialised tools, equipment, service and solutions for the Rail Infrastructure Projects

Key Tools/Equipment

- Impact Wrenches
- Rail Drills
- Threading Tongs
- Derails
- Chocks
- Rail Jacks
- Rail Wheel-Set Trolley
- Maintenance, Construction and Safety Equipment
- Re-Railing Equipment
- Rail Puller
- Rail Saw
- Precision Measuring Instrument
- Hydraulic Rail Tensor Hoses
- Spike Pulling Bar
- Rail Cut-Off Discs
- and Much More...

Major Clients



Key Partners



Significant Projects

- ◆ **SYDNEY METRO 2017- STAGE 1;**
Client: CPB - JOHN HOLLAND - UGL; Supply of Hydraulic Tools to TBM Install Team and Mechanical Maintenance Crews.
- ◆ **2019- STAGE 2 (Ongoing);**
Client: JOHN HOLLAND - CPB - GHELLA; Supply of Hydraulic tools for TBM Maintenance and Tunneling Teams.
- ◆ **GOLD COAST RAIL PROJECT;**
Client: MDGS-JV; Gold Coast and Bundamba



Specialised tools, equipment, service and solutions for companies, extractors and contractors in the Oil & Gas sector

Key Tools/Equipment

- Flange Maintenance
- Flange Spreading Tools
- Torque Wrenches
- Bolt Protection Caps
- Flange Closing Tools
- Wire Rope Cutters
- Flange Alignment Tools
- Bolt Tensioners
- Flange Spreading Wedge
- Nut Splitters
- Hydraulic Cylinders
- Cribbing Block Set
- Hydraulic Couplers & Fittings
- and Much More...

Major Clients



Key Partners



Significant Projects

- ◊ ATTWOOD OCENICS FOR WOODSIDE PETROLEUM OFFSHORE PLATFORM DRILLING MODULE; Supply of Heavy Duty Hilman Lifting Rollers and Hydraulic Equipment



Specialised tools, equipment, service and solutions for the Transport Industry

Key Tools/Equipment

- Hydraulic Puller
- Load Containment Nets
- Vehicle Lifting Jacks
- Container Trolleys
- Maintenance and Repair Kits
- Jacks, Presses, Pullers, and Torque Tools
- Battery Torque Tools
- Bead Breakers
- Torque Wrenches
- Track Pin Press
- Hydraulic Bottle Jacks
- Tyre Bead Breaker
- Cribbing Block Set
- Batteries & Chargers
- Tri-Glide Systems

and Much More...

Key Partners



Major Clients





Specialised tools, equipment, service and solutions for the Defence Industry

Key Tools/Equipment

- Hydraulic Valves & Couplings
- Impact Wrenches
- Load Rollers
- Impact Hammer Drill
- Flush Cut Saw
- Hydraulic Chainsaws
- Hydraulic Jacks
- Hydraulic Pumps
- Torque wrench pump
- Forklift jacks
- Hydraulic Breakers
- Hydraulic Capstan Winches
- Hydraulic pullers
- Rescue and maintenance sets - kits and Much More...

Major Clients



Key Partners



Significant Projects

- DEPARTMENT OF DEFENCE;**
 Supply of 187 Compac Floor Jacks With Special Extension Caps and Rubber Tyres. Jacks are for Use With Unimog Army Trucks. We Have also had Smaller Quantity Repeat Orders for Same Jacks Right Upto Now
- LEIGHTON CONTRACTORS FOR SUPPLY TO AUSTRALIAN DEFENCE INDUSTRIES;**
 Supply of Hilman Load Rollers for Moving Mine Hunter Boats at Carrington, Newcastle
- ARMY FOR ENGINEERS BRIDGES;**
 Supply of Jacking Equipment



Service & Solutions



Equipment
Service/Repair



Calibration
Capability



Installation and
Commissioning

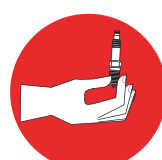

Spare Parts
Stock



Testing/Tagging
Capability

Service and Solutions You Can Trust

- ◆ National Network of fully equipped Workshops
- ◆ After Sales Service / Repair / Maintenance support for the Product Brands we offer along with alternative Brands
- ◆ Customer Site and Workshop based Test/Tag, Calibration & Audit Capabilities
- ◆ Product Application/Solution Technical support
- ◆ Tailored Asset Management Programs & Service
- ◆ Development of Customised Equipment/Asset Registers
- ◆ Training & Development of Personnel in the Safe and Compliant use of typical Products within our range

One Stop Workshop for Calibrating & Testing Precision Measuring Equipment

- ◆ Depth Micrometers
- ◆ Gauge Blocks
- ◆ Micrometer heads
- ◆ Vernier Calipers
- ◆ Dial Indicator (Plunger)
- ◆ Height Micrometers
- ◆ Outside Micrometers
- ◆ Vernier Height
- ◆ Dial Indicator (Lever)
- ◆ Inside Micrometers
- ◆ Riser blocks
- ◆ Gauge

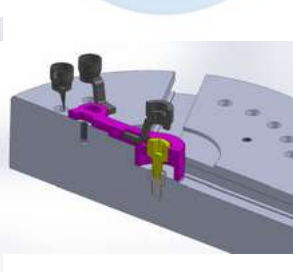
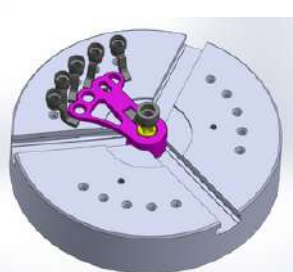
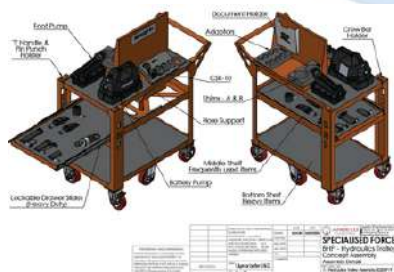
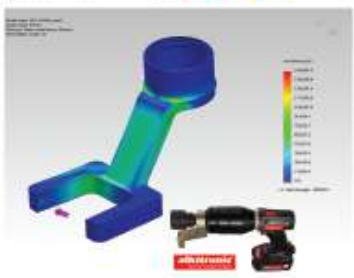



Sydney (Head Office)

131 WOIDS AVENUE
CARLTON NSW 2218
TEL: (02) 9547 1844
FAX: (02) 9547 2236
sales@specialisedforce.com.au

Melbourne

2/18 SOUTHFORK DRIVE
KILSYTH VIC 3137
TEL: (03) 9761 4199
FAX: (03) 9761 4966
vicsales@specialisedforce.com.au

Brisbane

2/68 NORTHLINK PLACE
NORTHGATE QLD 4013
TEL: (07) 3256 6011
FAX: (07) 3256 6055
qldsales@specialisedforce.com.au

Townsville

2/1 CIVIL ROAD
GARbutt QLD 4814
TEL: (07) 4728 8756
FAX: (07) 4725 4380
nqsales@specialisedforce.com.au

Adelaide

316 SOUTH ROAD
RICHMOND SA 5033
TEL: (08) 8352 8866
FAX: (08) 8352 7257
sasales@specialisedforce.com.au

Perth

19 AUGUSTA STREET
WILLETTON WA 6155
TEL: (08) 9354 8544
FAX: (08) 9354 8360
wasales@specialisedforce.com

Darwin

4/17 WILLES ROAD
BERRIMAH NT 0828
TEL: (08) 8984 4453
FAX: (08) 8984 4390
ntsales@specialisedforce.com.au

Port Hedland

4/13 CAJARINA ROAD
WEDGEFIELD WA 6721
TEL: (08) 9172 1113
FAX: (08) 9354 9360
phsales@specialisedforce.com

Hobart

22/370-380 CAMBRIDGE ROAD
MORNINGTON TAS 7018
TEL: 0427 423 217
FAX: (03) 9761 4966
tassales@specialisedforce.com.au

specialisedforce.com.au

