

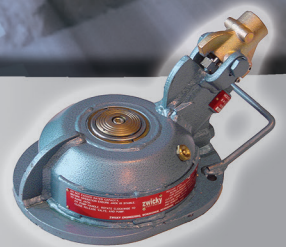

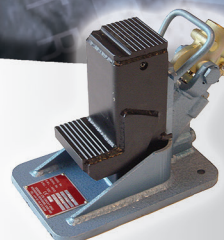

**SPECIALISED FORCE**  
HYDRAULIC TOOLS &  
ELECTRICAL CONTRACTORS EQUIPMENT  
PTY. LTD.

# ***Track Jacks & Wagon Stabilisers***



***[www.specialisedforce.com.au](http://www.specialisedforce.com.au)***





## TRACK JACKS & WAGON STABILISERS

168–181

JACK – SAFE D LOCK – DURAPAC	168
JACK – SCREW – ALDON	170
TRACK JACK – HYDRAULIC – DURAPAC	172
JACK – HYDRAULIC TOE – DURAPAC	174
TRACK JACK – HYDRAULIC – ZWICKY	176
AIR BAGS	178
AIR BAG ACCESSORIES	180
CRIBBING BLOCKS	181

## SAFE D LOCK

**The Safe D Lock jack is a revolutionary design with the operators' safety paramount. It is a lifting jack and rated vehicle jacking stand for heavy mining vehicles and locomotives.**

Australian designed and built to meet AS/NZS 2693:2007 standard for vehicle jacks, it also meets AS/NZS 2538:2004 standard for vehicle support stands. The jack uses patented oil-bathed internal locking quadrants that are constantly energised during the lifting process to give a fail safe operation. This locking mechanism automatically engages in the unlikely event of a hydraulic failure. The Safe D Lock jack is compact and portable and is the perfect choice for the workshop or service vehicle.

**DURAPAC**  
ENGINEERED FOR RELIABILITY



Model Number	Jack Capacity			Cylinder Effective Area (cm <sup>2</sup> )	Collapsed Height (mm)**	Stroke (mm)	Maximum Lift Height (mm) ***	Weight (kg)	Oil Tank Capacity (L)
	Metric (tonne)	US (ton)*	(kN)						
<b>SDL-07068</b>	70	77	686	143	680	404	1,408	290	24
<b>SDL-07081</b>	70	77	686	143	812	535	1680	320	24
<b>SDL-10068</b>	100	110	980	143	680	404	1,408	290	24
<b>SDL-10081</b>	100	110	980	143	812	535	1,680	320	24
<b>SDL-15068</b>	135	150	1,324	254	680	400	1,408	420	24
<b>SDL-15096</b>	135	150	1,324	254	960	685	1,680	460	24

\* Nominal Cylinder Capacity in ton - see kN values for actual capacity \*\* Includes load cap height of 22 mm

\*\*\* Maximum lift height for AS/NZS 2538:2004 Vehicle Support Stand Rating

Model Number	A	B
	Collapsed Height (mm)	Base Plate Diameter (mm)
<b>SDL-07068</b>	680	505
<b>SDL-07081</b>	812	505
<b>SDL-10068</b>	680	505
<b>SDL-10081</b>	812	505
<b>SDL-15068</b>	680	460
<b>SDL-15096</b>	960	520

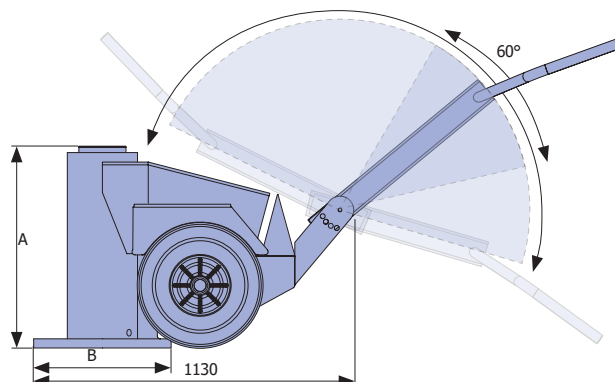
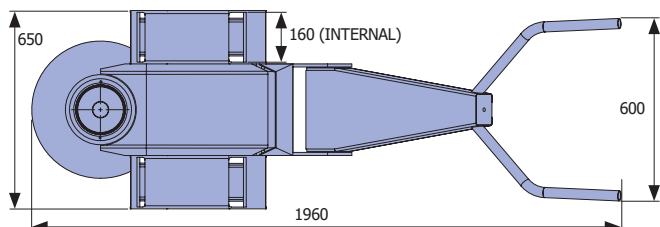

**DURAPAC**  
ENGINEERED FOR RELIABILITY

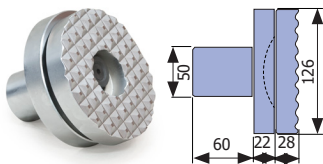
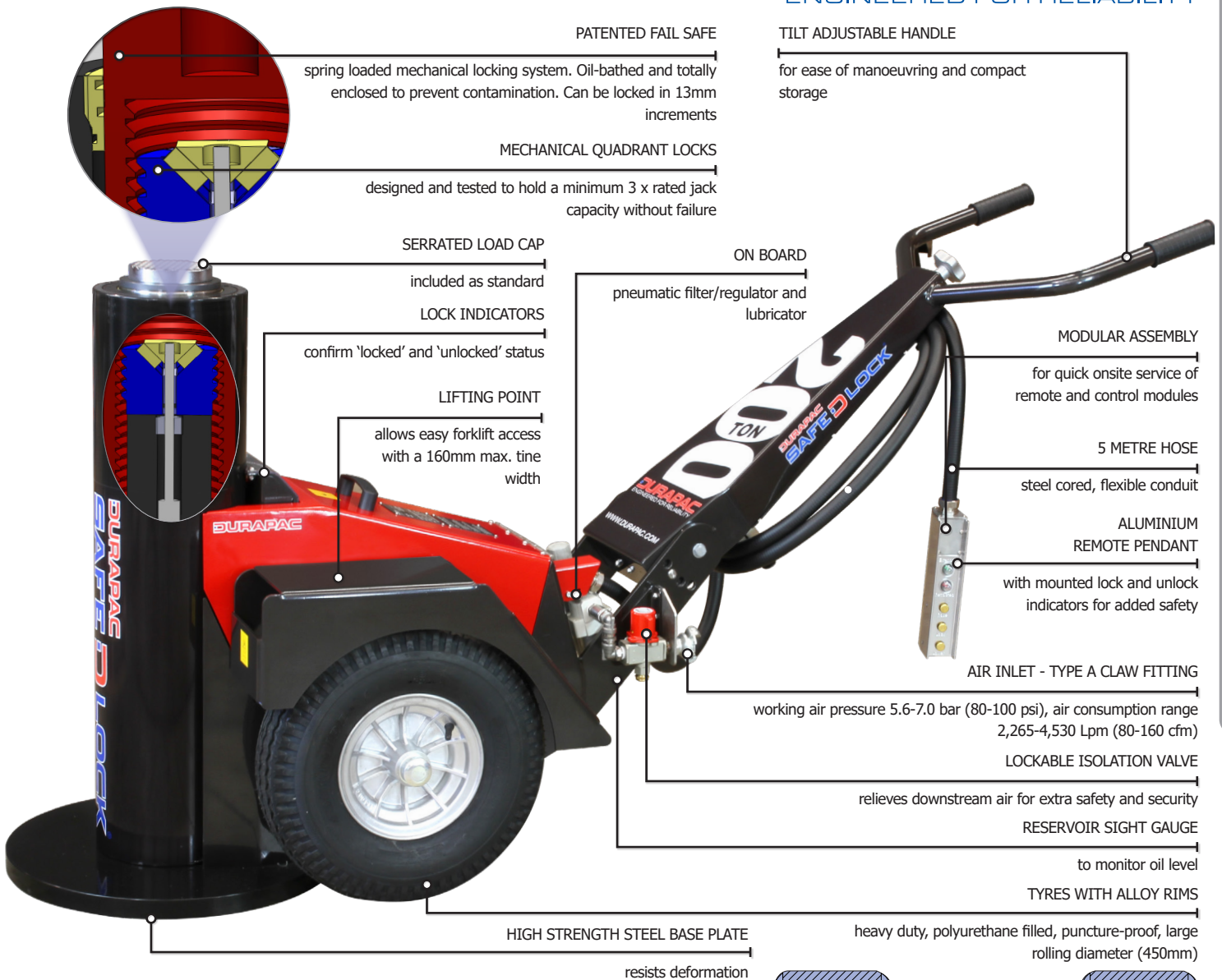

**SDS TILT SADDLE**

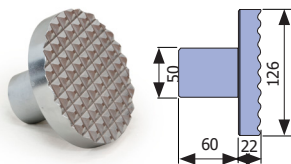

**SDLC LOAD CAP**

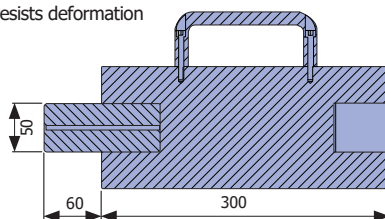

**EXTENSION 300mm**

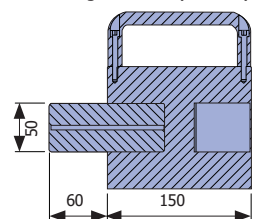

**EXTENSION 150mm**

Model Number	Capacity (Tons)	Description	Height (mm)	Diameter (mm) 'A'	Total Length (mm)	Spigot Depth (mm)	Spigot Diameter (mm)	Weight (kg)
<b>SDE100-150</b>	70/100	150mm Extension**	150	112	210	60	50	7.0
<b>SDE100-300</b>	70/100	300mm Extension**	300	112	360	60	50	13.0
<b>SDLC-100</b>	70/100	Serrated Steel Load Cap*	22	112	82	60	50	3.0
<b>SDS-100</b>	70/100	Serrated Tilt Saddle**	50	112	110	60	50	5.0
<b>SDE150-150</b>	150	150mm Extension**	150	126	210	60	50	7.0
<b>SDE150-300</b>	150	300mm Extension**	300	126	360	60	50	13.0
<b>SDLC-150</b>	150	Serrated Steel Load Cap*	22	126	82	60	50	3.0
<b>SDS-150</b>	150	Serrated Tilt Saddle**	50	126	110	60	50	5.0

\* Supplied as standard \*\* Optional item

## TRAILER STABILIZERS (MADE IN USA)

Designed solely for use in supporting the front end of semi-trailers.

### FEATURES

- Lightweight
- Powder coat finish
- No ratchet head screw to bend, rust or jam (4013-14 & 4013-15)

### ADJUSTABLE-HEIGHT SCREW JACK (MODEL NO. 4013-13)

**ALDON**  
CO

**GUARDIAN™**  
TRAILER STABILIZERS



Weights  
Only  
24.5kg



Height  
Adjustment:  
1067 - 1168mm

**Aldon® GUARDIAN™ Trailer Stabilizers**  
are designed solely for use in supporting front end of semi-trailers.

### FIXED-HEIGHT SCREW JACKS (MODEL NO. 4013-14 & 4013-15)

Most trailers dropped off at a dock are 1168mm (46") above the pavement. Aldon's 1143mm (45") Fixed Height Stabilizers slip in easily under the nose.

To adjust the trailer nose up or down, use lower gear setting of landing legs handle. It takes less than 30 seconds to lower 25mm (1") and less than 10 seconds to raise 6mm (1/4") to remove jacks.



**TRAILER STABILIZERS (MADE IN USA)**



**ALWAYS** use two jacks at the front of each trailer for good stability. A single jack in the centre will not prevent side-tipping. If one or both of the legs give way, a single jack in front will act as a fulcrum and not be able to overcome the tipping action. Trailer must be secured with dock lock or wheel locks.



**1**



**2**



**3**

**SPECIFICATIONS**

Model No.	Pic Ref #	Description	Tested Load Capacity* (Tonne)	Height (mm)	Top (mm)	Base (mm)	Weight (kg)
<b>4013-13</b>	1	Adjustable-Height Screw Jack	34.0	1067 - 1168	127	356	24.5
<b>4013-14</b>	2	Fixed-Height Screw Jack	34.0	1143	127	356	20
<b>4013-15</b>	3	Fixed-Height Screw Jack	34.0	1143	127	356	9

\* Load Capacity based on actual vertical loading. Load test reports available upon request. **Be careful when comparing capacity claims between different brands of trailer jacks. The true measure of strength in a jack is its tested load bearing capacity.**

## HYDRAULIC TRACK JACK

**DURAPAC**  
ENGINEERED FOR RELIABILITY

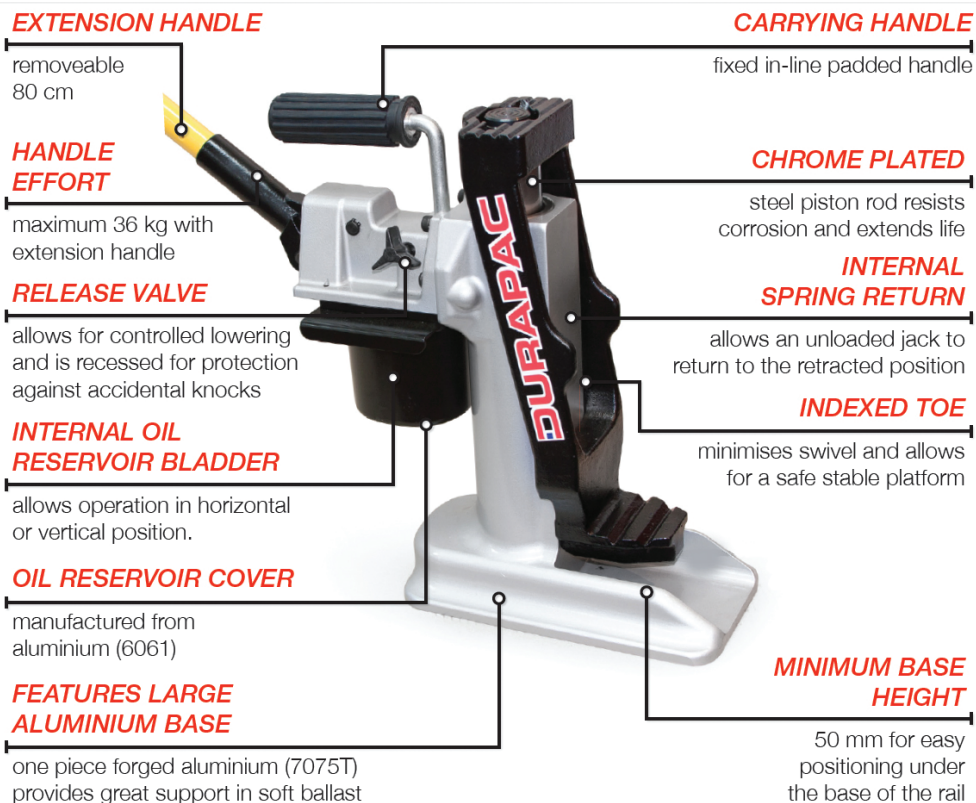

### Did you know...

Durapac DRJ-10 has an accessory anchor point that is located in the top of the jack.

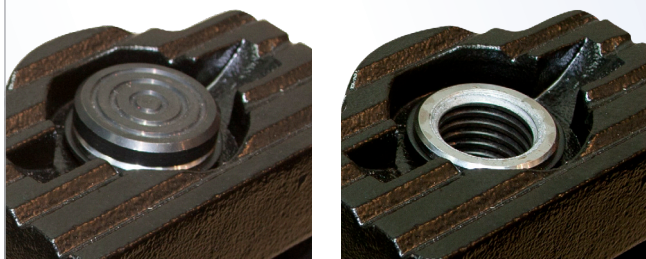

## HYDRAULIC TRACK JACK

### MODEL NO. DRJ-10 & DRJ-15

SUITED for ALIGNING, GAUGING and LIFTING OF RAIL or SLEEPERS.

Utilising a forged aluminium upright base both model jacks have been designed to be robust, lightweight and reduce the risk of operator injury. Both models have a spring return mechanism that will allow the jack with no load to be returned to the retracted position. These jacks are fitted with an internal safety pressure relief valve to protect against overloading. The bladder system inside the aluminium protected reservoir allows the jacks to be used in both the horizontal and vertical positions making them exceptionally versatile.

**DURAPAC**  
ENGINEERED FOR RELIABILITY



**DRJ-10**



**DRJ-15**

**QUICK RELEASE**  
for fast retraction speed

## SPECIFICATIONS

Model No.	Capacity		A	Stroke (mm)	B	Travel/ Pump Stroke (mm)	L x W x H	L1 x W1 x H1	Weight without Handle (kg)
	(ton)	(kg)	Collapsed Height (mm)		Extended Height (mm)		Base Dimensions (mm)	Toe Dimensions (mm)	
DRJ-10	10	9,072	373	225	598	4.5	280 x 152 x 50	66 x 79 x 30	20.2
DRJ-15	15	15,000	400	220	620	4.1	250 x 160 x 53	64 x 95 x 60	20.1

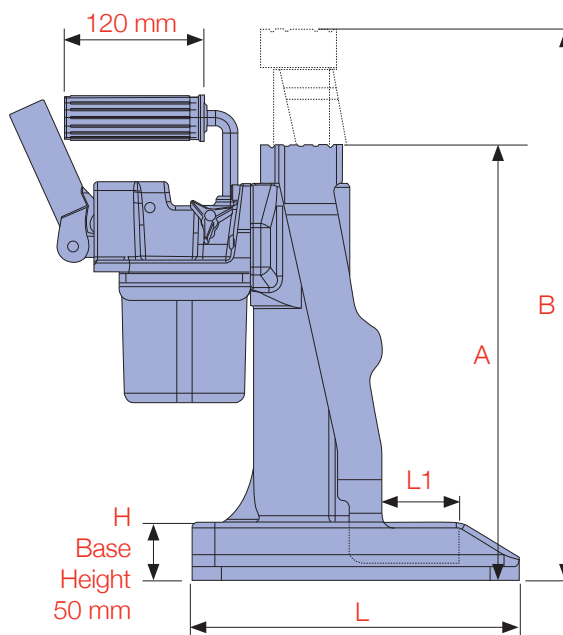
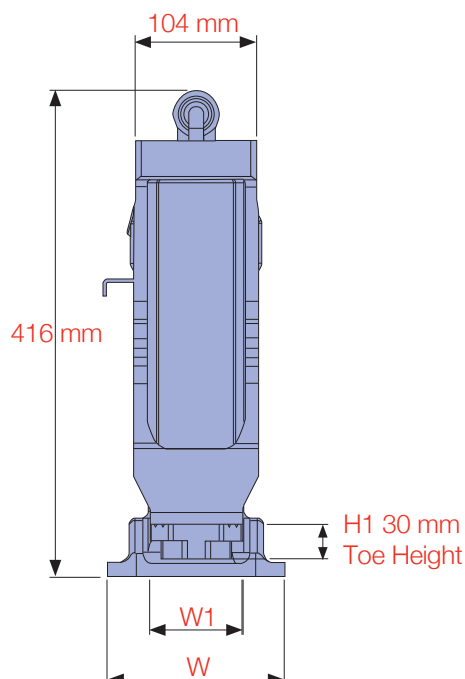

## MODEL NO. DTJ SERIES

The DTJ-Series toe jacks are a premium range ideally suited for lifting heavy machinery or equipment when access height is restricted.

Toe lift capacities range from 2.5-25 ton and all models feature a keyed toe with spring return piston.

**DURAPAC**  
ENGINEERED FOR RELIABILITY

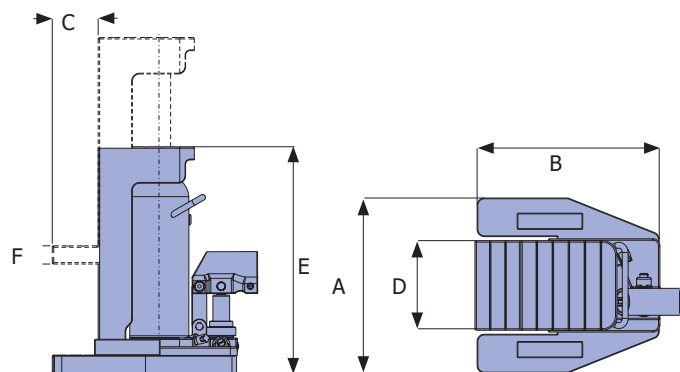

### CHROME PLATED

steel piston rod resists corrosion and extends life

### DOVETAIL DESIGN

for perfect alignment of toe during lift (25 ton jack does not have dove tail design)

### EASE OF USE

all jacks have been designed for ease of use and handling

### CARBON STEEL BASE

is welded to ensure increased resistance to high pressure and provide greater durability

### OPERATING HANDLE

included with all models

### 360° ROTATING

pump handle on models 2.5-15 ton

### INTERNAL STROKE LIMITER

prevents piston rod over-extension

### LIFTING TOE

manufactured from high strength alloy steel

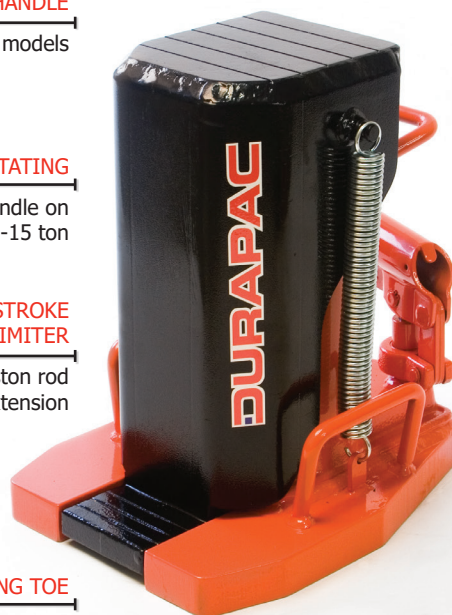

Model No.	Jack Capacity ton* / kN		A Jack Width (mm)	B Jack Depth (mm)	C Toe Length (mm)	D Toe Width (mm)	E Collapsed Height (mm)	F Min. Toe Height (mm)	Stroke (mm)	Weight (kg)
DTJ-2.5	2.5	24.5	126	233	60	50	232	19	110	11.6
DTJ-5	5	49.0	182	259	60	75	282	22	130	22.0
DTJ-10	10	98.0	215	275	63	85	320	28	140	32.0
DTJ-15	15	147.0	238	297	60	85	328	30	140	42.0
DTJ-25	25	245.1	320	368	60	125	364	34	150	100.0

\* Nominal Jack Capacity in ton - see kN values for actual capacity

# DURAPAC

## CATALOGUE

- Specialty Lifting System
- Cylinders
- Hand Pumps
- Electric Hydraulic Power Units
- Air Hydraulic Power Units
- Diesel Power Units
- Hydrostatic Power Units
- System Accessories
- Bolting Solutions
- Pullers
- Bearing Separators
- Hydraulic Cutters
- Maintenance & Repair Kits
- Hydraulic Presses
- Hydraulic Jacks
- Power Lift Air Bags

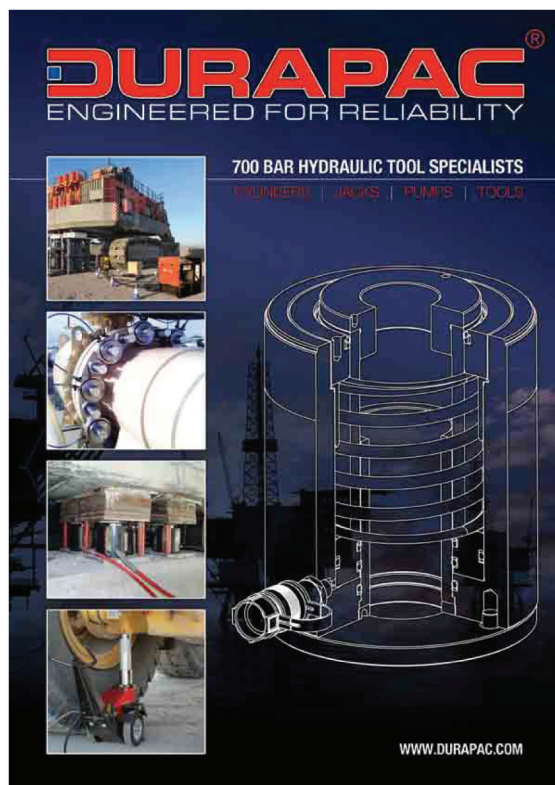

**CONTACT SPECIALISED FORCE FOR YOUR HARD COPY**



## HYDRAULIC TRACK JACK (MADE IN UNITED KINGDOM)

**zwicky**

Zwicky track jacks have been used by maintenance teams throughout the world for over 70 years, and have acquired a well-earned reputation for being the most durable and effective jack of its type on the market.

The 805BR Toe Jack heads up the range with a capacity of 8 tonnes whilst the F1054 Pan Jack is capable of 10 tonnes. Despite the Pan Jack's low closed height of 95 mm, it boasts a 101mm lift, thanks to its telescopic hydraulic ram. Both jacks, like their 20 tonne F1527 big brother, are obstructionless.

The obstructionless Zwicky SB7417 Track Aligner has a unique product design that is used for the aligning and slewing of track, points and crossings. All models are fitted with an overload safety valve. It features a swivel head which allows it to be positioned against the web of any rail including flat bottom rails.

Standard paint finish is hammered blue - alternative colour coding is available upon request. All models are available with either standard operating levers or insulated, which are specifically designed for third rail applications.



**805BR**

Toe Jack



**F1527**

Toe Jack



**F1054**

Pan Jack

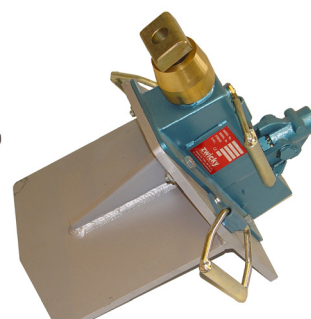

**SB7417**

Track Aligner (Aluminium Base Needs to be Anchored in Ballast)

### FEATURES

- Overload safety valve
- Tested to 25% over rated capacity
- Obstructionless

### SPECIFICATIONS

Model No.	Type	Main Purpose / Use	Suits Rail	WLL on Head (kg)	WLL on Toe (kg)	Closed Height (mm)	Toe to Head (mm)	Stroke (mm)	Unit Wt (w/o handle) (kg)
<b>805BR</b>	Toe Jack	Under rail without removal of ballast	42kg & Over	8	5	235 (Head) 95 (Toe)	140	90	18.5
<b>F1527</b>	Toe Jack	Switches & Crossings	42kg Rail & Over	20	15	343 (Head) 191 (Toe)	152	110	36.0
<b>F1054</b>	Pan Jack	Under rail without removal of ballast, Telescopic Ram	-	10	-	95	-	101	16.5
<b>SB7417</b>	Track Aligner	Aligning and slewing of track, points and crossings, Swivel Head	-	8	-	-	-	152	24.2

**HYDRAULIC TRACK JACK (MADE IN UNITED KINGDOM)**

**zwicky**



Model No	RB/BR/054	RB/BR/055
Description	A standard lever to suit all Zwicky hydraulic track jack models	An insulated lever designed for use with third rail applications and with high voltage resistance. Suits all Zwicky hydraulic track jack models
Material	Steel, Zinc Plated	Fibre Glass / Steel
Weight (Kg)	3.2	2.5



**A Standard Lever is Supplied with Each Jack or Aligner.  
Insulated Lever Available Upon Request.**

**TRACK JACKS & WAGON STABILISERS**

**www.specialisedforce.com.au**

## KEVLAR® POWER LIFT AIR BAGS

The KPL-Series high-pressure air bags feature Kevlar® cord reinforcing. The patented construction utilises state-of-the-art design for long life and ease of use. Metal parts are solid brass. The bags are thin, light and simple to use. Two bags can be stacked safely on top of each other thanks to the special dimpled surface. Eleven models of air bag are available with lifting capacities ranging from 1,000 to 65,900 kg.



Did you know...  
That you can use two air bags stacked on top of each other to increase the lifting height?



## KEVLAR® POWER LIFT AIR BAGS

### RUBBER DIMPLES

on contact surfaces for positive gripping

### CROSSHATCH REINFORCING PATTERN

made from Kevlar®

### CENTRING CROSS

and printing are brightly coloured and bonded to the rubber for long life

### FIREPROOF & ANTISTATIC

for use in underground coal mines (use AB-4 & AB-5 controllers)

### 1/4"-NPT AIR NIPPLE

is replaceable

### REINFORCING EDGE

protects the bag from damage

### CAPACITY

800 - 70,400 kg

### MAXIMUM LIFTING HEIGHT

80 - 520 mm

### MAXIMUM OPERATING PRESSURE

8 bar

### LIFTING CAPACITY VS LIFTING HEIGHT GRAPH

maximum lifting capacity

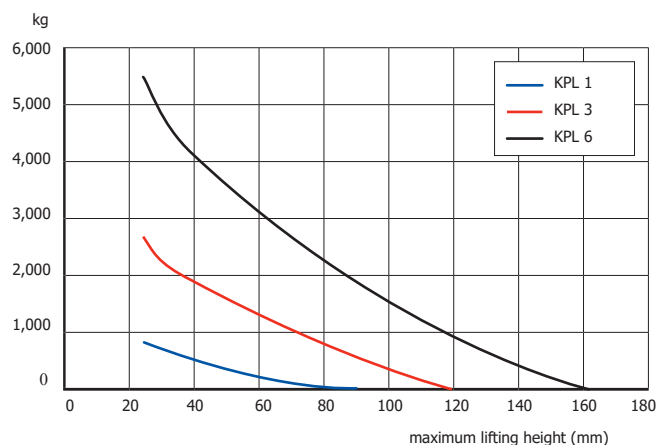

maximum lifting capacity

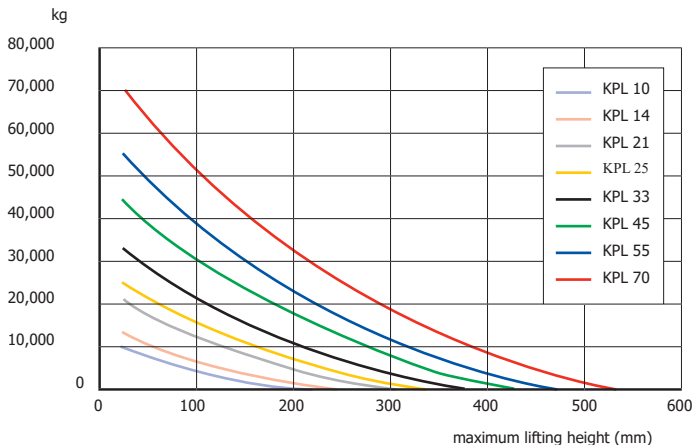

Model No.	Max. Lifting Capacity (kg)	Max. Lifting Height (mm)	Thickness (mm)	Insertion Height (mm)	Dimensions (cm x cm)	Max. Air Requirement (L)	Max. Inflation Pressure (bar)	Min. Burst Pressure (bar)	Weight (kg)
KPL 1	800	80	25	26	15 x 15	5	8	32	0.55
KPL 3	2,700	130	25	26	22.5 x 22.5	15	8	32	1.25
KPL 6	5,500	160	25	26	30 x 30	42	8	32	2
KPL 10	10,100	210	25	26	38 x 38	86	8	32	3.5
KPL 14	13,500	250	25	26	45 x 45	152	8	32	5
KPL 21	21,100	300	25	26	55 x 55	296	8	32	7
KPL 25	25,200	340	25	26	61 x 61	416	8	32	9
KPL 33	33,000	380	25	26	69 x 69	621	8	32	11
KPL 45	44,600	420	25	26	78 x 78	921	8	32	14
KPL 55	55,000	470	25	26	87 x 87	1,305	8	32	18
KPL 70	70,400	520	25	26	94.5 x 94.5	1,505	8	32	22.5

## SAFETY CONTROLLERS AND ACCESSORIES ALLOW THE EFFICIENT AND SAFE USE OF THE KPL-SERIES AIR BAGS.

Single and dual deadman controllers with pressure gauge and pressure relief valves offer maximum air bag inflation and deflation control, while single and dual safety controllers offer a cost effective and reliable air bag control solution. Hoses, connectors, shut-off valves and pressure regulators allow maximum flexibility in the air bag system.

ABHR-5, ABHB-5, ABHY-5 5M RED/BLUE/YELLOW ABHR-10, ABHB-10, ABHY-10 10M RED/BLUE/YELLOW

Hoses - available in 5/10m in RED/BLUE/YELLOW with male and female air coupler fitted.



AB-1

Single Deadman Controller - with pressure relief valve and pressure gauge. Controls one air bag.



AB-2

Dual Deadman Controller - with pressure relief valves and pressure gauges. Controls two air bags from one air source.



AB-3

Deluxe Dual Deadman Controller - with built-in pressure relief valves and pressure gauges and pressure sensitive toggle controls. For precise inflation and deflation of two air bags.



AB-4

Single Safety Controller - with pressure relief valve and pressure gauge. For inflation and deflation of one air bag.



AB-5

Dual Safety Controller - with pressure relief valves and pressure gauges. For inflation and deflation of two air bags.



ABC-1Y

Y-Connector - connector allows control of two bags with one controller.



ABCR-1

Pressure Regulator Controller - diaphragm type single stage regulator suits high pressure air tanks.



ABV-1

Inline Shutoff Valve - with 0.5 metre whip hose

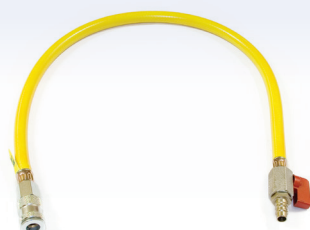

ABV-2

Inline Shutoff Valve - with relief valve



## STEEL CRIB KIT MODEL NO. 15002

- Steel cribbing is durable - will not bend or warp
- Model 15002 is a complete set. It includes one each of 76.2, 152.4 and 228.6mm stands
- Units can be nested together for 457mm total height
- Recessed area on cribbing fits 177.8mm square plate on 50 tonne cylinders
- Each unit contains carrying handle



Model No	Capacity (Tonne)	Kit
<b>15002</b>	90	1 x 15012, 1 x 15022, 1 x 15032

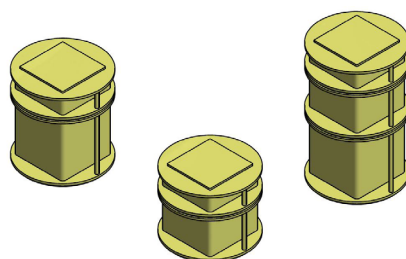

## 15002 KIT CONTENTS

Model No.	Height (mm)	Width (mm)	Recess Area (mm)	Weight (kg)
<b>15012</b>	76.2	304.8	177.8 x 177.8	17.2
<b>15022</b>	152.4	304.8	177.8 x 177.8	21.3
<b>15032</b>	228.6	304.8	177.8 x 177.8	25.4

## Stacking Examples

## SUPER STACKER CRIBBING BLOCK KIT MODEL NO. 15255

- Certified and Tested
- Multiple sizes, shapes fit most applications
- Interlocking or aggressive non-slip surface
- Non-conducting plastic resists oil and most chemicals
- Does not splinter, like wood
- Carrying lanyards provided on all crib blocks
- Made from 100% recycled plastic
- Can be used with Lincoln log mating or pyramid mating
- Industrial Kit is ideal for use up to 77 tonnes (Can be rated up to 135,000 kg, depending on configuration)

Model No.	Capacity (Tonne)	Kit Contents	Weight (kg)
<b>15255</b>	77	3 x 15210, 6 x 15230, 1 x 14465	50.0

## 15255 INDUSTRIAL KIT CONTENTS

Model No.	Qty in Kit	Dimensions LxWxH (mm)	Colour
<b>15210</b>	3	101.6 x 101.6 x 457.2	Black
<b>15230</b>	6	152.4 x 177.8 x 609.6	Black
<b>14465</b>	1	305.0 x 305.0 x 38.10	Black



**Larger Capacity Block Kits Available on Request**



SCAN & PLAY

14465 Jack Plate

