

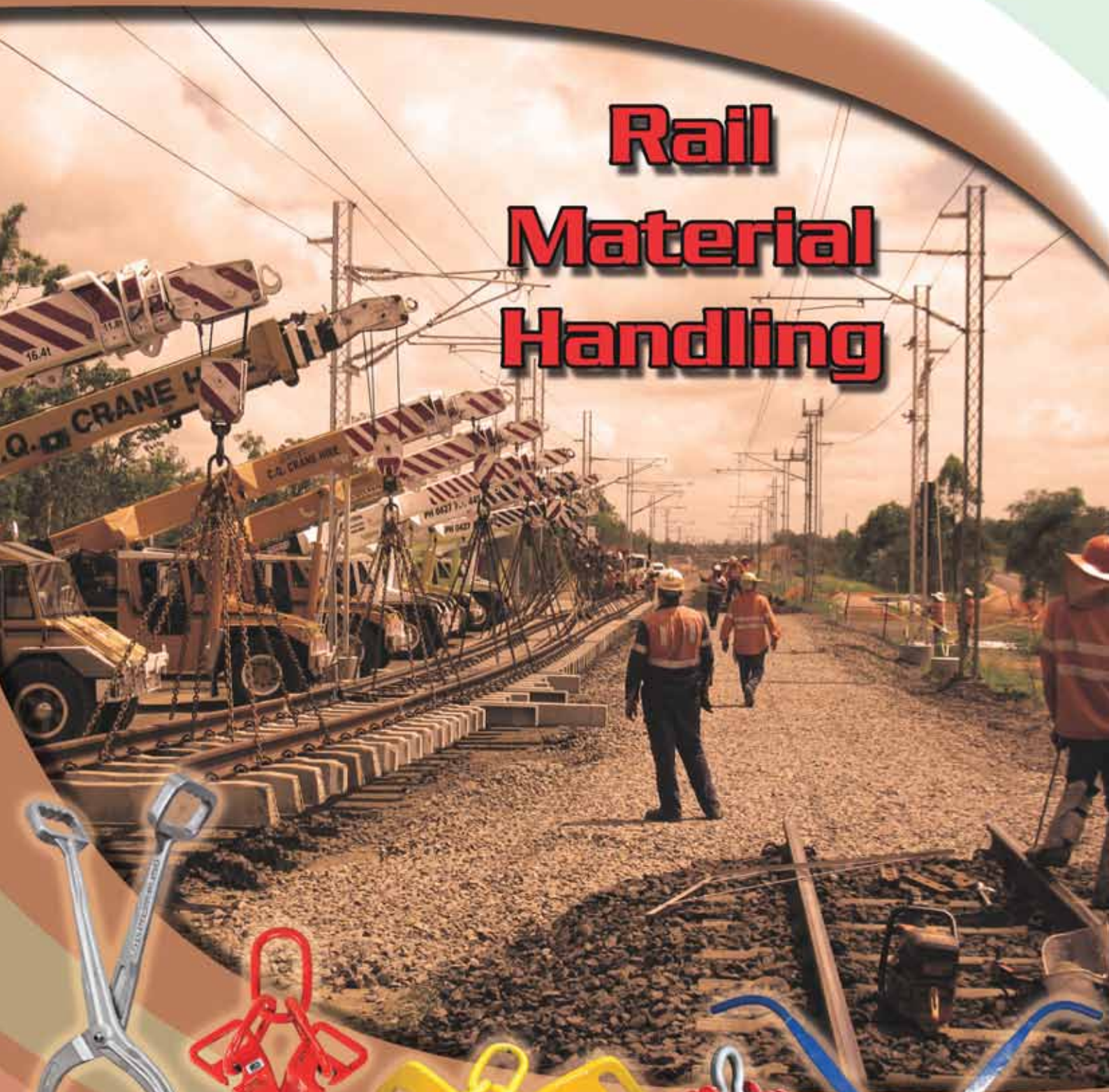

SPECIALISED FORCE
HYDRAULIC TOOLS &
SPECIALISED EQUIPMENT
PTY. LTD.

Rail Material Handling



www.specialisedforce.com.au



RAIL MATERIAL HANDLING

40–51

TONGS – RAIL – IPS	40
THREADING TONGS & SPREADER BARS – RAIL – IPS	42
TONGS – FROG LIFTING – IPS	43
TONGS – SLEEPER/TIMBER – IPS	44
PULLER & TUGGER – RAIL – IPS	45
THREADER – BALL & RAIL – IPS	46
RUNNER & THREADER – BALL & RAIL – IPS	47
HOOKS, TONGS & CLAMPS – LIFTING, HANDLING	48
TETHER CLAMP & TIE PLATE PULLER – IPS	49
HOOK – LIFTING , AUTOMATIC – GIGASENSE	50
RAIL SHOES & SLEEPER HANDLING EQUIPMENT – IPS	51



RAIL TONGS (MADE IN CANADA)

All IPS tongs are designed for long-term field performance and are made from high-strength alloy steel. Every tong is individually magnetic particle tested, pull test certified, and engraved with a serial number to maximise worker safety.

MODEL NO. RHD SERIES

RHD3.3-IPS



RHD6.0-IPS



RHD8-IPS



RHD10-IPS



FEATURES

- Manufactured from forge cast high-strength alloy steel
- Rugged design for long term, high field performance
- Designed to open automatically when lowered onto the head of a rail
- Will handle most rail profiles
- Each tong is magnetic particle tested
- and proof load tested
- Pull test certified
- Engraved with a serial number to maximize worker safety
- Units type tested to a minimum of 5:1 safety factor lifting
- Two lifting handles (**RHD6.0/8 only**)

SPECIFICATIONS

Model No.	WLL Capacity (kg)	Type	Pivot Bolt	Proof Test (kg)	Suits Up to Rail (kg)	Unit Wt (kg)
RHD3.3-IPS	3,000	LITTLE DAWG	19mm / 3/4"	7,500	68	6.8
RHD6.0-IPS	5,400	RAIL DAWG II	32mm / 1-1/4"	13,607	68	22.7
RHD8-IPS	7,000	BIG DAWG	32mm / 1-1/4"	18,000	68	37.3
RHD10-IPS	9,000	MEGA DAWG	35mm / 1-3/8"	22,679	68	40.8



RHD3.3-IPS



RHD6.0-IPS



RHD8-IPS On 68kg Rail



RHD10-IPS

RAIL TONGS (MADE IN CANADA)



RHD3.3-IPS

3,000kg

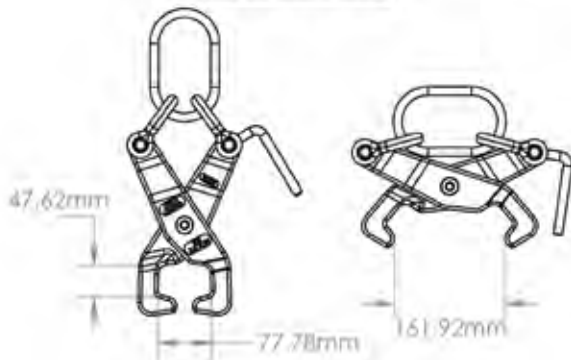

RHD6.0-IPS

5,400kg

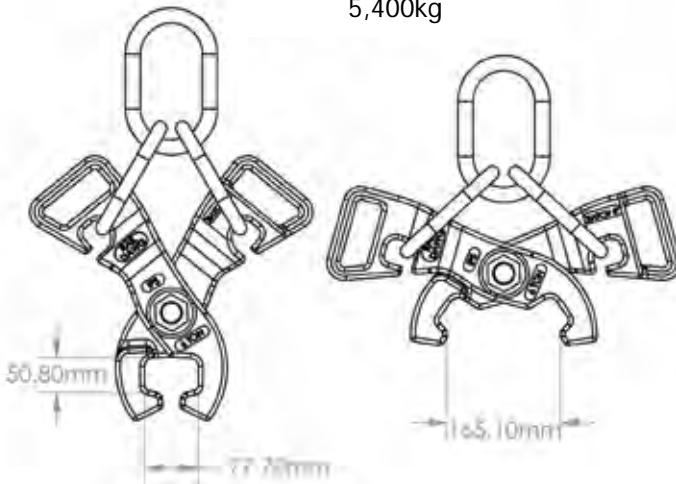

RHD8-IPS

7,000kg

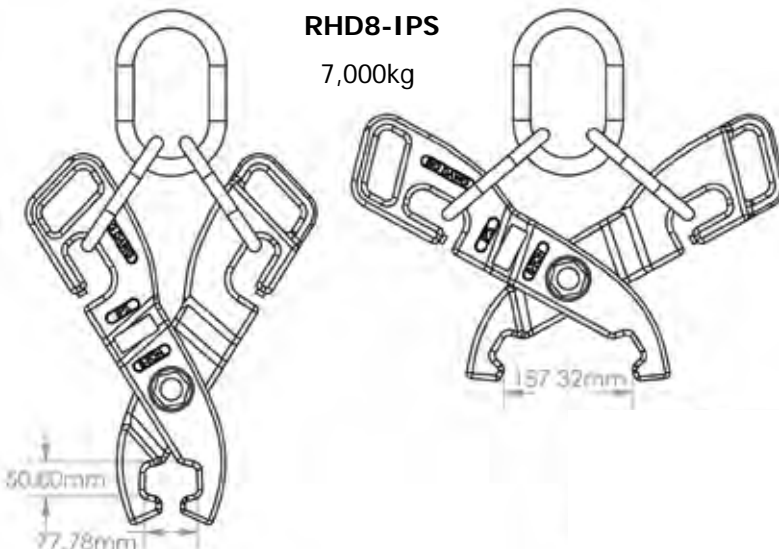

RAIL MATERIAL HANDLING

www.specialisedforce.com.au



RAIL THREADING TONGS & SPREADER BARS (MADE IN CANADA)



Model No. LSB-IPS-IU is a spreader bar that features 2 x RH3.3-IPS refer pages 40–41 for tong details only

RAIL THREADING TONG – MODEL NO. VARIOUS

The “Jefferson” Rail Threading Tong is a unique high-performance rail threader that operates like a conventional rail threader, but has 2 rollers mounted on each jaw of the tong to allow the rail to thread through the tongs. Supplied with a rounded handle for use with a crane hook.

FEATURES

- Magnetic particle tested
- Load Pull Tested
- Automatically opens when lowered onto rail head
- Replacement roller assemblies available
- Available upon request square handle for use with IPS rail tongs only



2310045A



2310045B

SPECIFICATIONS

Model No.	WLL (kg)	Proof Test (kg)	Handle Type	Replacement Roller	Dimensions (mm)	Unit Wt (kg)
2310045B	2,721*	4,000	Crane Hook	2310045A-01	317 x 254 x 610	61.8
2310045A	2,721*	4,000	Square Handle	2310045A-01	317 x 254 x 610	62.7

SPARE PARTS

Model No.	Description	WLL (kg)
2310045A-01	Complete with axles, bearings, lock washers and nuts	9.0





FROG LIFTING TONGS / FROG DAWG II TONGS (MADE IN CANADA)

All IPS tongs are designed for long-term field performance and are made from high-strength alloy steel. Every tong is individually magnetic particle tested, pull test certified, and engraved with a serial number to maximise worker safety.

MODEL NO. FHD6.0-IPS

Frog lifting tongs designed to lift most styles of railway frogs with a minimum safety factor of 3.6.



FEATURES

- Magnetic particle tested
- Load Pull Tested
- Manoeuvring unit handles keeps operator hands free of "pinch" points when positioning tong

SPECIFICATIONS

Model No.	Capacity (kg)	Proof Test (kg)	Dimensions (mm)	Unit Wt (kg)
FHD6.0-IPS	5,443	19,594	673 x 432 x 203mm (813mm with handle raised)	27

SPREADER BAR (MADE IN CANADA)

MODEL NO. LSB-IPS-IU

IPS manufactures a lightweight spreader bar complete with 2 Little Dawg Rail Tongs (RHD3.3-IPS). Designed and certified with a 1,814kg working load limit and designed to lift longer lengths of rail.

FEATURES

- Supplied with 2 x RH3.3-IPS lifting tongs
- Tested & certified

SPECIFICATIONS

Model No.	WLL (kg)	Proof Test (kg)	Unit Wt (kg)
LSB-IPS-IU	1,814	2,721	37.3



MODEL NO. TT2.2-IPS SLEEPER / TIMBER TONGS (MADE IN CANADA)

Includes replaceable tips designed specifically for lifting sleepers, wood and timbers with machinery. Designed for long-term field performance and made from high-strength alloy steel. Individually magnetic particle tested, pull test certified, and engraved with a serial number to maximise worker safety.

FEATURES

- Cast from high strength alloy steel.
- Jaw profile designed to handle wide range of sleeper and timber sizes
- Replaceable tips (Model No. **T-500-IPS**) available in 12.7mm



Model No.	Tong Type	Dimensions (mm)	Replacement Tips #	Unit Wt (kg)
TT2.2-IPS	Sleeper	267 x 77 x 597	T-500-IPS	10.1



MODEL NO. 2310108A HAND SLEEPER / TIMBER TONGS (MADE IN CANADA)

Efficient lightweight design for ease of manual handling and long term performance. Ergonomic handles and designed with removable tips. Supplied with two installed grasping tips. Replaceable tips are heat treated and high-strength, 89mm long with a 9.5mm diameter shank, complete with nut and lock washer for use with both fabricated and cast aluminium sleeper.

FEATURES

- Made from high quality cast Aluminium
- Light weight and ergonomic
- Designed for individual hand use
- Replacement Tips available (Model No. 2310109A)



SPECIFICATIONS

Model No.	Tong Type	Dimensions (mm)	Replacement Tips #	Unit Wt (kg)
2310108A	Sleeper	787 x 286 x 134	2310109A	3.5

MODEL NO. 4123 SERIES TIMBER SLEEPER TONGS

Lifting tongs used on timber sleepers for rail.



SPECIFICATIONS

Model No.	Image #	Description	Jaw Opening (mm)	Unit Weight (kg)
4123-15	1	Skidding Tongs	553	4.5
4123-14	2	Two-Man Rail Tong	95	8.6
4123-93	3	Timber Dragging Tongs	508	6.8
4123-87	4	Tie Carrier (Crane Type)	483	16.8
4123-88	5	Timber Carrier (Crane Type)	737	23.8
4123-85	6	Aluminium Tie Tong (Replaceable Tip)	394	4.1
4123-23	7	Two-Man Timber Tong	394	5.5
4123-21	8	One-Man Tie Tong	394	4.5



RAIL PULLER (MADE IN CANADA)

MODEL NO. 2310000C

The Cyclops II Rail Puller has positive cam-lock action to prevent slippage when pulling long lengths of rail. Its unique cam design will accommodate most rail profiles. The Cyclops II Rail Puller has a 22,679kg working load limit, based on a safety factor of 2, is manufactured from high-strength steel alloy and is designed to pull 402 metre lengths of rail. It can also be connected to a crane hook without a shackle.



FEATURES

- Magnetic Particle Tested
- Cam-lock enhanced rail-grip
- Folds down for storage/transport to: 305x280x255mm

SPECIFICATIONS

Model No.	Dimensions (mm)	WLL (kg)	Proof Test (kg)	Unit Wt (kg)
2310000C	305x203x381 Folds to (305x280x255)	22,679	45,358	37

RAIL TUGGER (MADE IN USA)

RAIL TUGGERS - MODEL NO. VARIOUS

Do not attempt to lift rail with tuggers, they are designed for pulling purposes only – **NOT FOR LIFTING**.



Model No.	Model No.
4123-72	4106-24
FEATURES	FEATURES
Has a self-locking wedge to tightly grab rail. Use Tugger to drag or position 12m lengths of rail. Handles rails 45-64kg/m Always pull horizontally. Do not use on Crane Rail.	Custom sized for a specific crane rail size and section. Steel wedge dogs clamp to rail head for positive anchoring. Pull horizontally to drag or position 12m lengths of rail. Pulling direction must always be in the direction shown above, so wedge drives itself into slot between wedge dogs. Unit can also be used as a rail anchor for pulling an inoperative overhead crane by means of a come-along puller.

SPECIFICATIONS

Model No.	Suits Rail Type	Maximum Length of Rail (m)	Handles Rails	Wt (kg)
4123-72	Standard "T"	12	45-64kg/m	18.2
4106-24	Crane	12	Crane Maximum Limit 1,814kg	7.7 (Approx. Depends on rail size)



BALL & RAIL THREADERS (MADE IN CANADA)

The IPS Bull Dawg Rail Threader is robust and designed with high quality bearings and rollers to ensure long-lasting performance. Available with either square handle for use with the IPS rail tongs or the triangular, peaked (hook) handle for use with a crane hook. The threaders are designed to be easily unlocked, opened then dropped over the top of the rail then closed and re-locked.

FEATURES

- Heavy duty rollers
- Manufactured from high-strength steel
- Rugged design for long term, high field performance
- Will handle most rail profiles
- Test certified
- Engraved with a serial number
- 5:1 safety factor for lifting



SPECIFICATIONS

Model No.	Handle Type	WLL (kg)	Proof Test (kg)	Unit Wt (kg)
2310044C	Square	5443	7,257	129.3
2310044D	Hook	5443	7,257	127.0

Model No.	Description	Dimensions (LxW) (mm)	Weight (kg)
1347	Replacement pivot bar and roller assemblies to suit 2310044C & 2310044D. Complete with heavy duty rollers, bearings and axles.	381 x 102	13.6



RAIL THREADER MODEL NO. HDT-500

At just 43.1kg, the Hound Dawg rail threader provides heavy-duty performance in a comparatively light and easy to handle unit. Heavy-duty rollers are designed with protected bearings for long term performance.



FEATURES

- Hardened rollers with enclosed bearings for increased durability
- Lifting Bell locks into upright position
- Replaceable heavy-duty rollers & bearings available.

SPECIFICATIONS

Model No.	Dimensions (mm)	WLL (kg)	Replacement Heavy Duty Rollers & Bearings Model No.	Unit Wt (kg)
HDT-500	406 x 381 x 254 (355 with handle raised)	4,535	HDT-500-01	43.1



Replacement rollers are supplied complete with axle, bearing, lock washer and nut.
HDT-500-01



BALL/RAIL THREADERS & RAIL RUNNERS (MADE IN CANADA)

RAIL THREADER MODEL NO. 2310004C

This robust threader with hinged door is manufactured with heavy-duty rollers and bearings and is designed for welded rail. Replacement rollers available.

FEATURES

- Hardened rollers with enclosed bearings for increased durability
- Lifting Bell locks into upright position
- Replaceable heavy-duty rollers & bearings available



SPECIFICATIONS

Model No.	Dimensions (mm) LxWxD	Replacement Heavy Duty Rollers & Bearings Model No.	Replacement Bearings Wt (kg)	Unit Wt (kg)
2310004C	673 x 711 x 483	2310004C-01	20.0	168.2

RAIL RUNNER

MODEL NO. 2310055A

The IPS Railrunner is a heavy duty rail handling device for laying new rail. Ideal for use with wooden or concrete sleepers. Unique design allows units to be locked together into compact stacks to minimise freight costs and storage requirements. Units can be positioned to work between sleepers or spiked to the top of wooden sleepers. Space Railrunners every 10-20 sleepers for maximum field performance.

FEATURES

- Unique lock together design
- Heavy duty construction

SPECIFICATIONS

Model No.	Unit Wt (kg)
2310055A	20



RAIL RUNNER STORAGE SYSTEM - MODEL NO. 2310055A-03

This heavy-duty frame is designed to store up to 50 railrunners and can also be used as a shipping crate. The storage system is designed to be moved with forklift or overhead crane.

Model No.	Frame Weight (kg)
2310055A-03	132



RAIL MATERIAL HANDLING (MADE IN AUSTRALIA)

SLEEPER LIFTING HOOK

MODEL NO. SLH1.5T

High quality powder coated lifting hook for lifting rail sleepers.

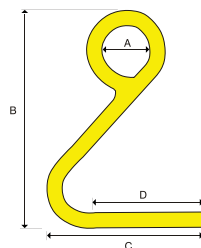

Model No.	WLL (kg)	Dimensions (mm)					Unit Wt (kg)
		A	B	C	D	E	
SLH1.5T	800/Pair	50	240	170	125	19	1.1

RAIL LIFTING TONG

MODEL NO. RLT3T SERIES

High quality forged lifting tong, automatically opens on the head of the rail. Available as standard or locking model.

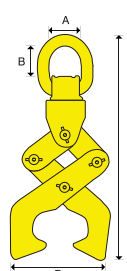

Model No.	WLL (kg)	Suits Rail (kg)	Dimensions (mm)					Unit Wt (kg)
			A	B	C	D	E	
RLT3T	3,000	41-68	48	46	370	150	50	8.8
RLT3T-LOCK	3,000	41-68	48	46	370	150	50	8.8

COLLAR TYPE RAIL LIFTING CLAMP

MODEL NO. RLC2.5T SERIES

Suits rail from 41-68kg

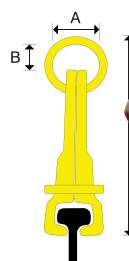

Model No.	WLL (kg)	Suits Rail (kg)	Dimensions (mm)				Unit Wt (kg)
			A	B	C	D	
RLC2.5T	2,500	41-68	100	75	440	65	11.5

RAIL ROLL OVER HOOK

MODEL NO. RORH

High quality powder coated roll over hook for turning over rail. NOT TO BE USED FOR LIFTING.

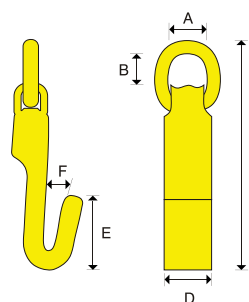

Model No.	WLL (kg)	Dimensions (mm)						Unit Wt (kg)
		A	B	C	D	E	F	
RORH	2,000	40	35	255	50	85	20	2.9



RAIL HANDLING EQUIPMENT (MADE IN CANADA)

RAIL TETHER CLAMP - MODEL NO. RTC-550



The IPS Rail Tether Clamp is a unique tool that allows rails to be off-loaded safely. Designed to attach quickly to the end of a rail, the tether clamp allows a worker to guide and control a rail during loading and unloading, and minimises the risk of accidental employee injury and property damage. Rope and attachment clasp included.

SPECIFICATIONS

Model No.	Length of Rope (m)	Clamp suits Rail Size (kg)	Unit Wt (kg)
RTC-550	15.2	41-68	2.0

SLEEPER PLATE PULLER - MODEL NO. TPP-42S

This lightweight tool is designed to safely, quickly and easily adjust the position of sleeper plates.



SPECIFICATIONS

Model No.	Length of Handle (m)	Unit Wt (kg)
TPP-42S	1.07	0.8

AUTOMATIC LIFTING HOOK (MADE IN SWEDEN)

MODEL NO. IS SERIES

This new concept saves time and increases safety. Lifting operations with mobile cranes and industrial hoists can safely be managed by the operator alone. The operator can remain at the controls during lifting and release operation.

FEATURES

- Automatically hooks up, safety locks and releases
- The risk for injury is dramatically reduced
- No climbing or assistance required

The GIGASENSE IS Hook consists of hook, housing and link. Forged hook, housing and link are of high-grade alloy steel. Unloaded, the spring loaded hook is pulled up against the housing in an open, ready-to-load position where it can easily be hooked onto a lifting eye or other attached hardware.



NOTE: SLINGS ARE NOT RECOMENDED FOR USE WITH AUTO-LIFTING HOOK

1. When the GIGASENSE IS Hook is engaged, the load tension closes the hook and the safety latch is automatically locked.
2. The hook remains safety locked even if it is unloaded. It is therefore possible to safely set down the load and make sling adjustments.
3. To release the safety lock after completed lifting operation, the hook is lowered until the upper link has tilted approximately 60° in relation to the housing.
4. When the lock is released, the hook swings up into an open starting position.
5. The load is released, and the hook is ready for a new lifting operation.



HOOK UP
Lifting eye or sling.



LOWER
After completed lifting operation the GIGASENSE IS Hook is lowered until it tilts into release position and opens.



LIFT
When the GIGASENSE IS Hook is engaged, the load tension automatically safety locks the hook and housing assembly.



RELEASE
The GIGASENSE IS Hook automatically frees itself from the load and is ready for the next lifting operation.

The Hook is tested and approved by the Swedish Institute for Materials Testing.

Available in 6 sizes from 1.6 - 21.6 tonnes. Easy to operate, has rugged design and a high reliability.

Applications include but are not limited to; Blasting mats, pipes, pumps, machines, gas bottles and general lifting.

Transport Case and a list of spares are available upon request. Please contact your nearest Specialised Force branch for more information.

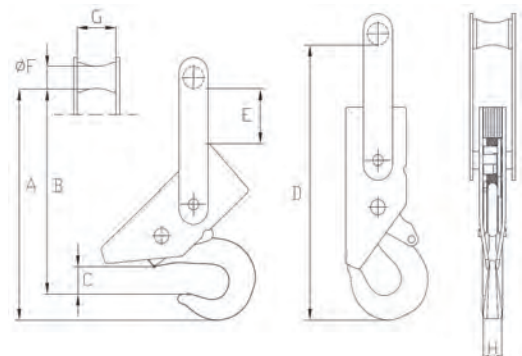

SPECIFICATIONS

Model No.	Type	WLL (Tonne)	Locking Force (kg)	Dimensions (mm)								Wt (kg)
		Safety Factor 5:1		A	B	C	D	E	F	G		
300159	IS-2	1.6	40-50	310	280	60	340	80	20	42		3.0
300165	IS-5	4	50-70	360	325	50	430	90	32	67		6.7
300161	IS-10	8	200-250	490	425	65	580	110	44	58		15.0
300162	IS-15	12	500-700	525	460	80	625	115	54	72		24.0
300163	IS-20	16	600-800	580	500	80	700	130	65	83		37.0
3001515	IS-27	21.6	500-1500	608	530	100	725	125 Lock 175 Release	65	92		37.0



MODEL NO. RSL-800 RAIL SHOE (MADE IN CANADA)

Lightweight rail shoe to facilitate dragging lengths of rail without catching on terrain or other obstacles. Also referred to as rail skidding shoe or rail dragging shoe.



Model No.	Dimensions LxWxH (mm)	Max Bolt Size (mm)	Unit Wt (kg)
RSL-800	470x127x165	31.75	5.9

SLEEPER HANDLING EQUIPMENT (MADE IN THE UK)

High quality powder coated lifting hook for lifting rail sleepers.

Model No.	Description	Model No.	Description
RB/BR/007B	Pandrol Housing Sleeper Hook - Left	RB/BR/007A	Pandrol Housing Sleeper Hook - Right
RB/BR/225E-L	E Clip Dropper Chain Assembly Left	RB/BR/225E-R	E Clip Dropper Chain Assembly Right
39/68953	E Clip Sleeper Scissor Lifter Rb/Br/142	RB/BR/080	Fastclip Lifting Plate
RB/BR/142/ASSY	E Clip Scissor Dropper Chain Assembly	RB/BR/225FC	Fastclip Dropper Chain Assembly



Pandrol 'E' Clip	Sleeper Lifter	Fastclip
Tests have shown a staggering 12 to 1 safety factor (based on 350Kg WLL). Available in left and right hand versions.	Designed to be used in conjunction with dropper chains to suit. Designed to be used in conjunction with dropper chains to suit.	The fastclip dropper chain has been developed for fast insertion on both F41 and G44 fittings. Designed to be used in conjunction with dropper chains to suit.
Standard Pandrol 'E' Clip dropper chain consists of:	Standard Pandrol 'E' Clip dropper chain consists of:	Standard Pandrol 'E' Clip dropper chain consists of:
TSH 7/8 Clevis Hook 7mm Grade 8 Short-link chain (BS EN 818:4) INJ 7 Connector Pandrol 'E' Clip hook	TSH 7/8 Clevis Hook 7mm Grade 8 Short-link chain (BS EN 818:4) K7N Kupler Sleeper Lifter	TSH 7/8 Clevis Hook 7mm Grade 8 Short-link chain (BS EN 818:4) INJ 7 Connector Fastclip hook